



Yuasa Technical Data Sheet

Yuasa B38-6A - Conventional 6 Volt Battery

Performance

Voltage	6
Capacity (10-hour)	13Ah
Capacity (20-hour)	13.7Ah

Dimensions (±2mm)

Length	119mm
Width	83mm
Height	161mm

Weights & Measures

Mean Weight with Acid	2.9kg
Acid Volume	0.62l

Technology

Technology	Cast Sb/Sb
Separator	Reinforcing fiber+Glass Fiber

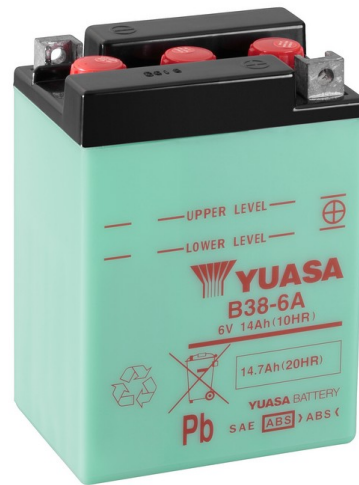

Cell Assembly Layout

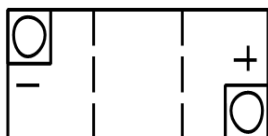

Terminal Type - 6

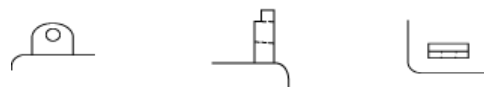

Data Sheet generated on 25/11/2024 - E&OE